

PLASTER-IN PROFILES: P05B

CHARACTERISTICS

Anodised aluminium profile for trimmed plaster-in flush recessed installation. Recessed support along the profile for perfect stability.

CAN BE USED WITH LED STRIPS WITH MAXIMUM WIDTH:

10 mm.

MAXIMUM POWER

15W/m

MATERIALS

6063 aluminium profile with white polycarbonate screen.

ACCESSORIES INCLUDED

Every 3 metre bar is complete with 3 end caps (with and without hole).

INSTALLATION

For recessed installation in plasterboard or ceilings with tiles. Cabling can be in line with the profile or exit the bottom of the profile.

PACKAGE

Supplied in packages of 5 bars, each one measuring 3 meters complete with screen and accessories. Spare accessories available with separate code.

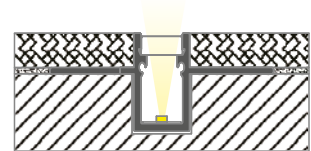
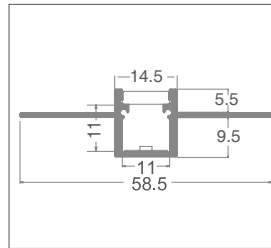

Cutting Project profiles to size*:

fixed cost of piece work

VA04

* Includes mounting accessories.

IP20	IK10
------	------

art	Description	L1	H	L	8011905	
P05B-S-PF-300	PC screen and accessories	58,5	15	3000	913069	1 / 5

MAX 10mm ♦ To be discontinued



art	Description	8011905	
P05B-A-EC	3+3 PC silver colour end caps	913076	1

♦ To be discontinued